

Modular Cabinets

Modular Cabinets is a collection of storage cabinetry designed for business and institutional applications. Comprised of wall, base and storage units, Modular Cabinets provides a built-in custom look anywhere traditional millwork cabinetry is required.

QUALITY CONSTRUCTION

- Unique installation system uses wall-mounting rail and metal-to-metal cabinet connections, allowing freedom of change and ensuring structural integrity
- Wall cabinets are tested to hold 580 pounds on a 72-inch-wide wall rail
- Wall and base cabinets are available from 12 to 42 inches wide
- Base cabinets feature a 4-inch-high toe kick providing a comfortable work position when standing in front of the cabinet
- Base cabinet levelers offer a 3-inch leveling range adjustable from within the units once installed
- Cabinet cases are constructed of 1 1/16-inch-thick low-pressure laminate (45 pounds density) providing sturdy quality
- Solid door and drawer fronts are available in low- or high-pressure laminate and Teknion's Flintwood (reconstituted wood)
- Tempered glass doors are available in clear or frosted options
- Countertops and backsplashes are available with a special water-resistant construction for sink applications
- Designed for seismic zones/activity
- Included in Teknion's limited lifetime warranty



CABINETS: Solid Doors/Cases – Source Laminate, Storm White
Glass Doors – Frost with Foundation, Storm White frame
Handles – Mica, Platinum

COUNTERTOPS: Foundation Laminate, Storm White

TABLES: Surface – Seamless Color, Snapdragon
 Base – Mica, Platinum

ALTOS WALLS: Double Glazed Fascias – Frost/Clear
 Solid Fascias – Fascia Laminate, Storm White

SEATING: Nami Bar Stools, Shell – Storm White
 Frame – Chrome

Return on investment

- Modular Cabinets mounting rails fasten to wall studs, in contrast to millwork cabinets that require the wall to be blocked or reinforced which increases project costs
- Mounting rails also fasten to Teknion's Altos architectural walls, providing full integration of product lines
- Modular Cabinets' ability to be reconfigured and relocated offers a reduced cost of change and a cost-savings alternative to millwork
- For fiscal purposes, Modular Cabinets may be classified as either a construction cost or, in some jurisdictions, as office furniture allowing an accelerated depreciation

Environmental considerations

- Greenguard® certified for Indoor Air Quality
- Includes 94.7 percent recycled content
- Reusable cabinets result in reduction or elimination of natural resources, materials and demolition waste shipped to landfills – also helping companies achieve LEED-CI credits
- Ease of relocation and reconfiguration promote an environmentally responsible furniture alternative – again helping companies achieve LEED-CI credits
- Teknion offers FSC approved product as an option



CABINETS:
Doors/Cases – Source Laminate, Latte
Handles – Mica, Bronze

COUNTERTOPS:
Foundation Laminate, Evening Parchment

SEATING:
t-3 Stools, Upholstery – Fundamentals, Sudan

CABINETS:
Solid Doors – Flintwood, Pecan
Glass Doors – Frost with Mica, Platinum frame

Cases – Source Laminate, Storm White
Handles – Mica, Platinum

COUNTERTOPS:
Flintwood, Pecan

FREESTANDING SCREENS:
Frame – Mica, Platinum
Upper Elements – Frosted Glass
Base Elements – Source Laminate, Storm White

ALTOS WALLS:
Double Glazed Fascias – Frost/Clear
Solid Fascias – Flintwood, Pecan

SEATING:
Fitz, Upholstery – Gabriel Wool, Europost, Ecrú

Features

At a glance

Five handle styles offer aesthetic variation.

Shelves are adjustable every 1¼ inch and secure with a self-locking anti-tip support.

Wall cabinets with a microwave section provide above-surface mounted application.



Base cabinets provide a discreet waste bin/recycling center for kitchen applications.

Door hinges in options of 120 or 170 degrees (shown) offer optimal accessibility.

ADA-compliant units are available with or without doors for complete access below the surface.

Wall cabinets

standard wall cabinets
d 12", 15"
w 12"-48"
h 15", 24", 30", 36"

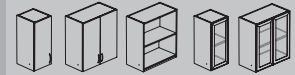

corner wall cabinets
d 12", 15"
w 24"-36"
h 24", 30", 36"

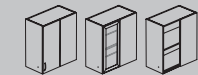

open wall cabinets
d 15"
w 12"-36"
h 30", 36"

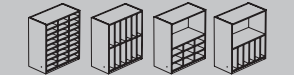

open wall cabinets with doors
d 15"
w 12"-36"
h 30", 36"

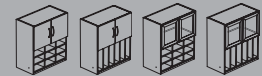

wall cabinets with microwave section
d 15"
w 24"-36"
h 30", 36"

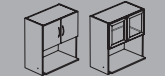

Base cabinets

standard base cabinets
d 24", 29"
w 12"-42"
h 33", 35"

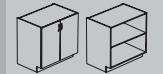

corner base cabinets
d 24", 29"
w 24"-36"
h 33", 35"



open base cabinets
d 24"
w 12"-36"
h 33", 35"

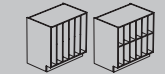

base cabinet for waste bin
d 24", 29"
w 18"
h 33", 35"

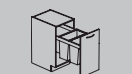

ADA sink base cabinets
d 24", 29"
w 33"-42"
h 33"

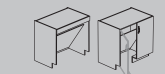

base cabinets
d 24", 29"
w 12"-36"
h 33", 35"

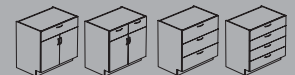

d 24", 29"
w 24"-42"
h 33", 35"



d 24", 29"
w 24"-36"
h 33", 35"



Storage cabinets

standard storage cabinets
d 24"
w 12"-36"
h 54", 72", 84"

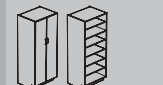

wardrobe storage cabinets
d 24"
w 24"-36"
h 54", 72", 84"



Accessories

wall support
w 72"

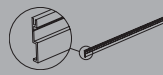

top filler
d 12"-24"
w 12"-48"
h 6", 12"

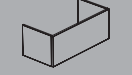

base filler
w 6"
h 33"-84"



side filler
w 6"
h 15"-48"



end panel for wall cabinet
d 12", 15"
h 15"-48"



countertop
d 25"-30"
w 12"-108"

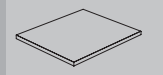

end gable
d 24", 29"
h 33", 35"



backsplash
w 12"-108"
h 4"



sidesplash
w 25", 30"
h 4"



shelf
d 12"-24"
w 12"-42"

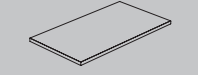

wall cabinet support kit for altos
h 15", 24", 30", 36"

